

# TECHNICAL DATA SHEET

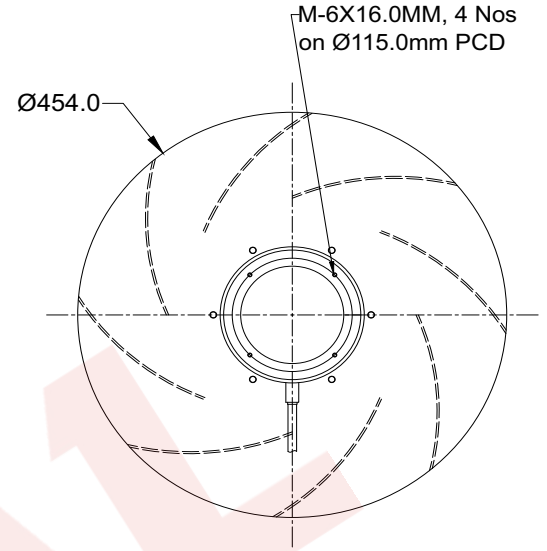
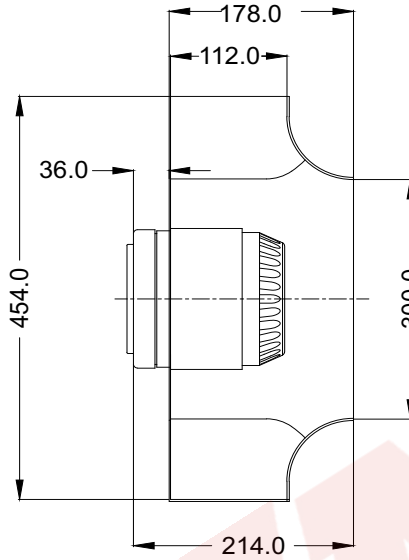

NOTE:- ALL DIMENSION ARE IN MM.

## SPECIFICATIONS (50 Hz)

Volt (V)	Watts (W)	Current (A)	Speed (RPM)	Capacitor (µF)	Air Vol. (m³/hr)	Noise (dBA)	Nt. Wt. (Kg)
230	520	2.45	1400	20.0	4750	80	12.0

## MECHANICAL CHARACTERISTIC

Impeller	Aluminum Powder Coated
Rotor	Powder Coated
Type Of Protection	IP-54
Motor Protected	Thermally Protected At 145° C
Insulation Class	"F"
Bearing	Maintenance Free Ball Bearing
Permissible Ambient Temperature	0° To 60° C
High Voltage Test According to IS	3588-1987
Direction Of Rotation	Counter clockwise Seen On Rotor,
Balacing Grade	Fans Conform 6.3 Grade As Recommended By IS 1940-1-2003

## PERFORMANCE CURVE

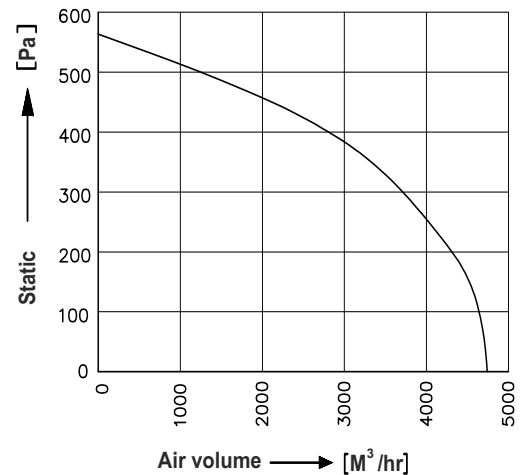

Conversion: 100pa ≈ 0.4" H2O 100m³/hr ≈ 60cfm

## WIRING DIAGRAM

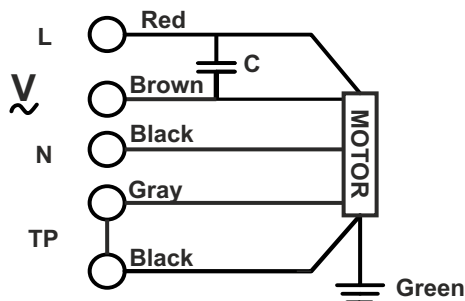

DRAWN BY	V.J.P	TITLE:- <b>MODEL : BC450-4E-M7</b>
CHECKED BY	J.G.P	
APPROVED BY	S.B.D	
SCALE N.T.S.	SHEET 1 OF 1	REV/DATE: 04,31.01.2018

Note:- All Information contained in this document is **CONFIDENTIAL** and the property of HETAL INDUSTRIES  
Reproduction of this in any form is to be done with the specific permission of the company.